

SGCNZ 2021

University of Otago Sheilah Winn Shakespeare Festival

Video Submission Information

Due to the ever-changing situation surrounding Covid, regional entries for the SGCNZ 2021 University of Otago Sheilah Winn Shakespeare Festival must have a backup video option available for online submission should their region go into a lockdown.

Below is all the info you will need for submission.

Key Notes

- You can use any devices and video skills available to you, including camera movement (zooming, panning, tilting, hand-held etc.), editing of shots and recorded sound etc, and in any setting – inside or outside. **But keep it simple - this is not a movie festival!!!**
- Sets must remain minimal, as per the Criteria, with potentially a 2 minute set up and strike.
 - Lighting should be basic – *'The play's the thing.'*
- A microphone should be placed at the front of the Stage (or relevant spot) to best capture your dialogue.
- All scenes must be registered on the University of Otago's SGCNZ Festival web Registration page: <https://www.otago.ac.nz/shakespeare/>
 - Schools/Homeschool Clusters must be current financial Friends of SGCNZ - <http://www.sgcnz.org.nz/join-us>
 - Files will be in .mp4 format.
 - Files must be a maximum of 2GB.
 - All files will be sent to glassgeckofilms@gmail.com
- Any questions related to Video Submission can be sent to glassgeckofilms@gmail.com
 - Any questions regarding the Festival can be sent to dawn@sgcnz.org.nz
 - **Due Dates** for submission are outlined at the end of this document.

Submission instructions

1. Head to <https://wetransfer.com/>

2. Click 'add files' and select the MP4 file you wish to send us (must be under 2GB).
(You do NOT need to sign up to/or register for WeTransfer. This is a free service)

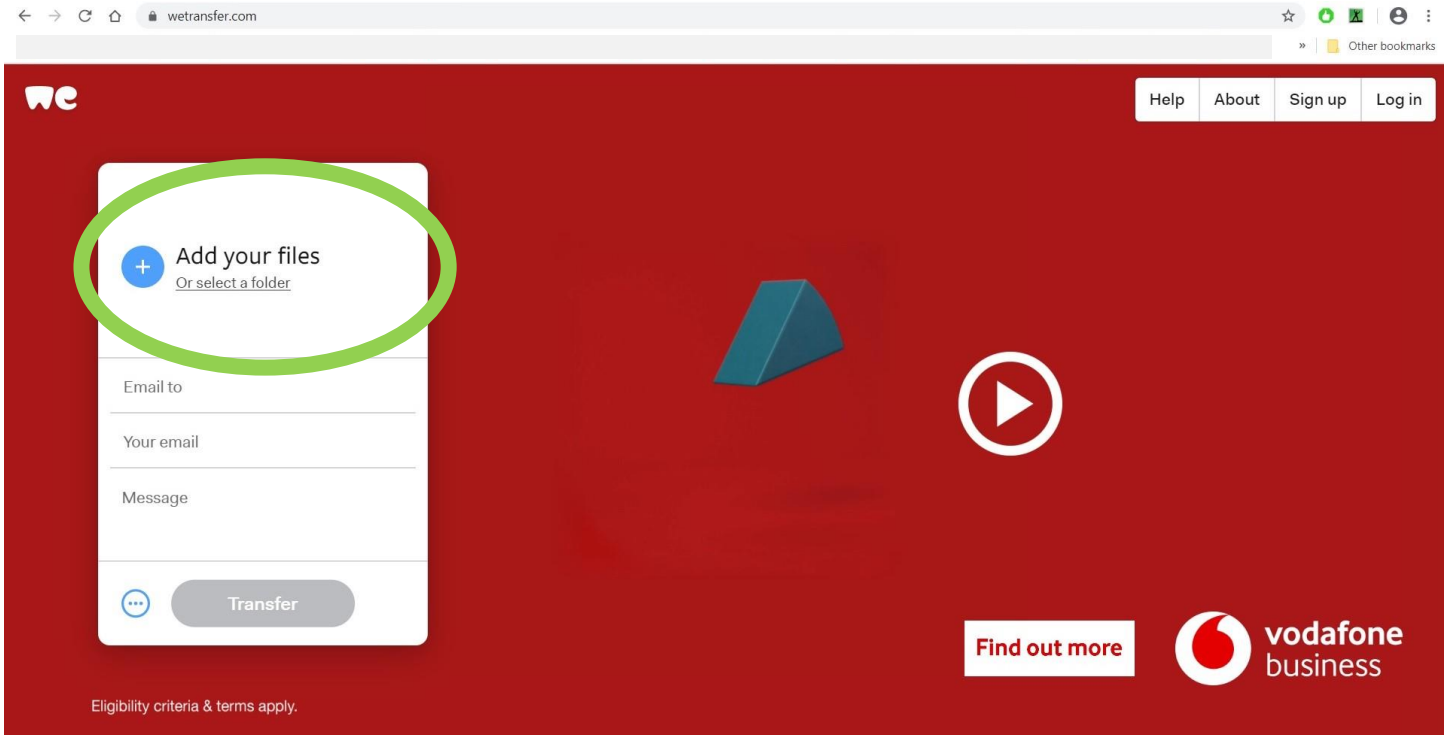

3. In 'email to' add: glassgeckofilms@gmail.com and then enter your own email address below
(this is where you will receive confirmation of transfer and of download at our end).

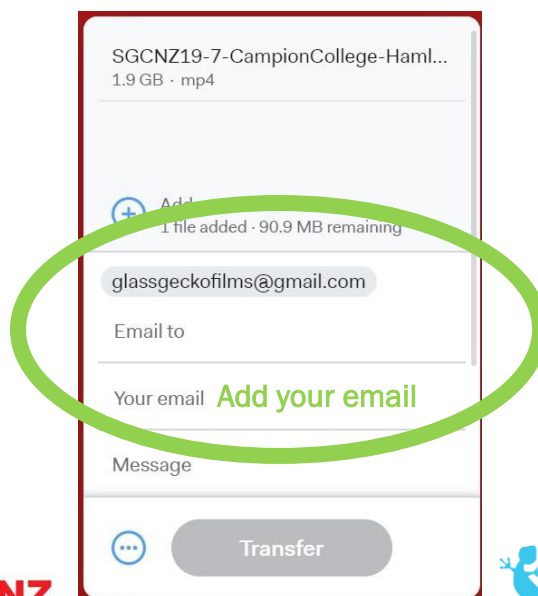

4. In the 'message' box, add:

Your Region:
Your School:
Your Performance: (Play Name, Act/s and Scene/s)
Play Duration: (4-5mins or 10-15mins)

Note: This step is very important to ensure everything is easily identifiable.

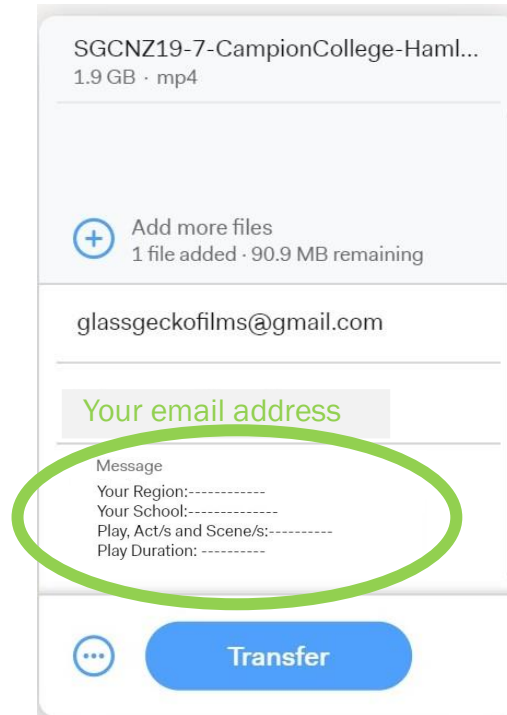

5. Click the blue 'Transfer' button and wait for the transfer to complete.
(For a 1.9GB file, on Fibre Broadband, in Wellington this took approx. 30mins)

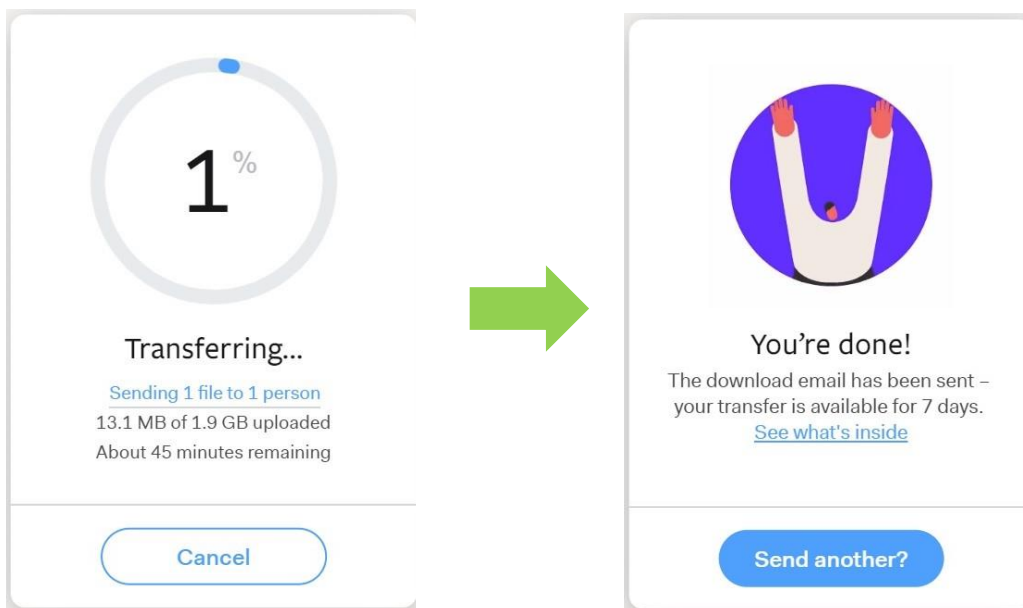

6. Once the transfer is complete, please send us a separate email to glassgeckofilms@gmail.com to confirm your file has been sent.

You're all done!

We will then download your file at our end and categorise them for assessment.
(you will receive another email confirming our download of your file).

Submission Due Dates

Register your scene/s as soon as possible.

All films must be submitted by the date that your regional festival was originally meant to take place.

Any further questions regarding the Festival can be sent to dawn@sgcnz.org.nz

All questions regarding video submission can be sent to glassgeckofilms@gmail.com
or 027 383 5182

Thank you for your co-operation and continued support.

Dawn Sanders and Glass Gecko Films